

FLOOR PLAN - PLUMBING ABOVE FLOOR
SCALE: 1/4"=1'-0"

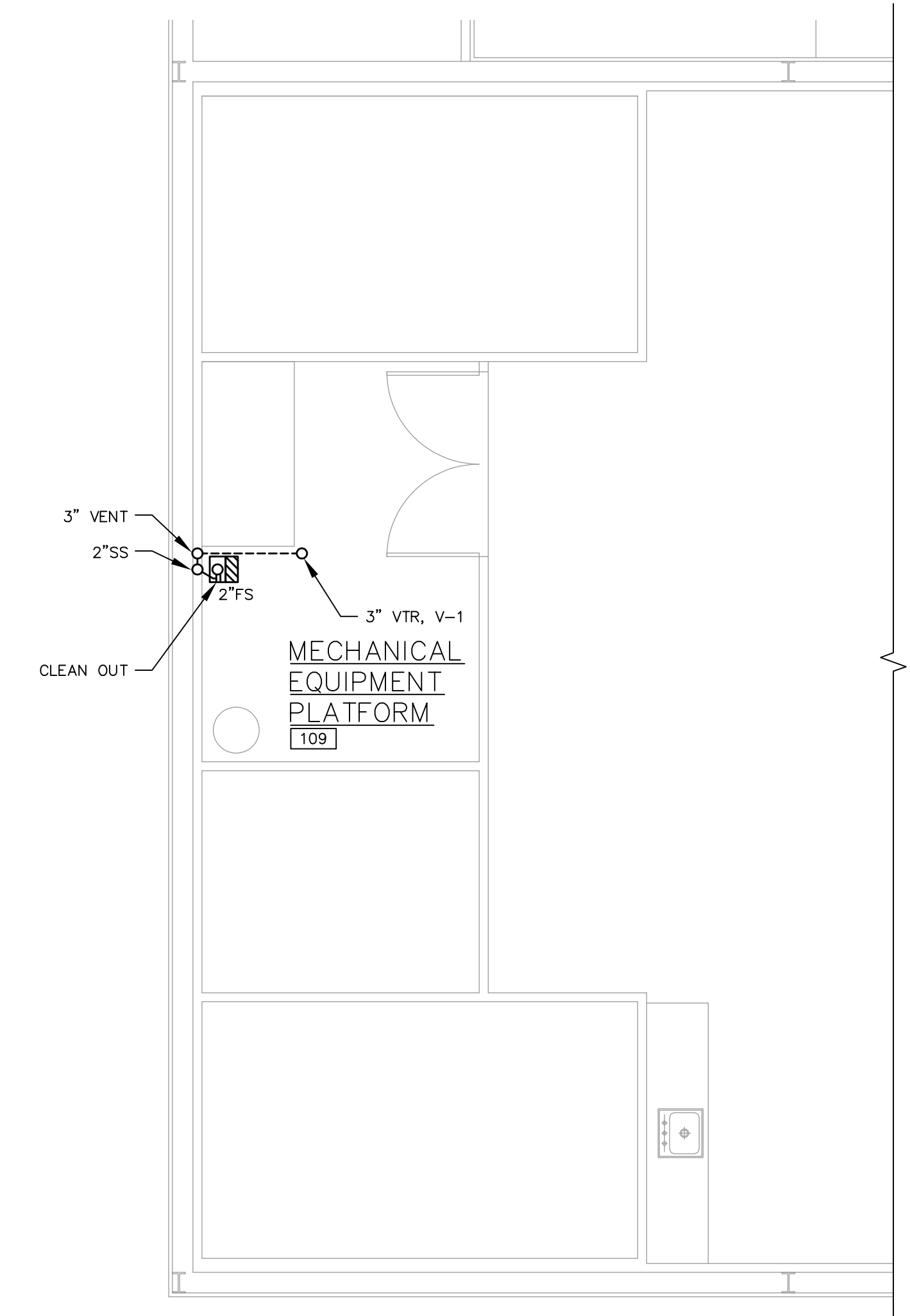

MECHANICAL EQUIPMENT PLATFORM FLOOR PLAN - PLUMBING
SCALE: 1/4"=1'-0"

SE PROJECT NUMBER: 23415

PREPARED BY:

SE SAMUEL ENGINEERING
6450 E. Crescent Parkway, Suite 200
Greenwood Village, CO 80111
Phone: 303.714.4840
Fax: 303.714.4800
TX-Registered Engineering Firm No. F13934

This document is copyrighted and is an instrument of service by Samuel Engineering (SE). It was prepared solely for the Owner's/Client's use on this project only. Use, copy or disclosure of any information shown, in whole or in part, without SE's consent, is strictly prohibited, is a copyright breach and may be prosecuted. Any unauthorized reuse shall be at the sole risk of the user.

THIS DRAWING REMAINS THE PROPERTY OF THE ARCHITECT AND IS NOT TO BE USED IN ANY WAY WITHOUT HIS PERMISSION

FRED B. PARKER • ARCHITECT
280 N. COLUMBIA
STEPHENVILLE,
TEXAS 76401
PH. (254)965-5358
FAX. (254)965-5393

PARKER & ASSOCIATES
ARCHITECTS & PLANNERS

FLOOR PLAN
MULTI-PURPOSE FACILITY FOR
RANGER COLLEGE
609 Cooper St. Ranger Tx. 76470

DATE OF REVISIONS:
REV 0 IFC 01/22/24

JOB NO.
23C09RAN

DRAWN BY:
PL

SHEET NO.
P-2